

GUARDSMAN GVS SERIES 2X2

Page 1 of 2

VANDAL RESISTANT 2'x2' RECESSED FLUORESCENT
STATIC 2, 3 OR 4 LAMP T8

Features

- Excellent for locations where vandal resistance is required.
- Prismatic lens (VL) is 3/16" thick pattern 12, minimum impact strength, 130 foot pounds.
- Prismatic lens (VK) is 9/64" thick pattern 12, minimum impact strength, 80 foot pounds.
- Full perimeter gasketing (closed cell Neoprene) between door frame and lens.
- Tamper resistant holt head screws secure lens to housing.
- 5" deep body.
- 69.3% efficient (T8).
- Hemmed over side rails for maximum safety.
- Fixture ends turned-in for safe handling.
- Built-in earthquake clips (patent no. 5,072,344).
- Spring loaded rooster head latches.
- 18 gauge steel hinges.



Mounting Methods / Features

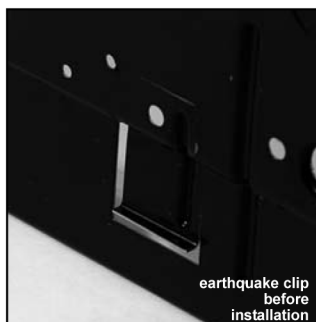
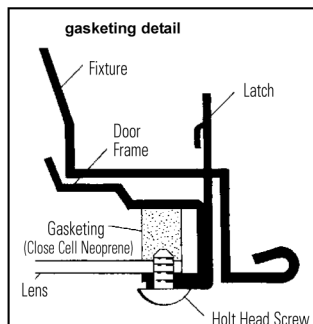
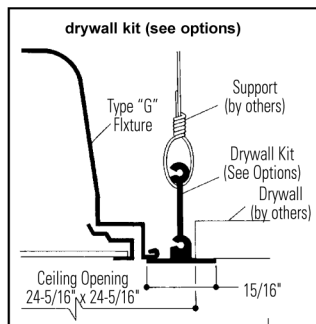
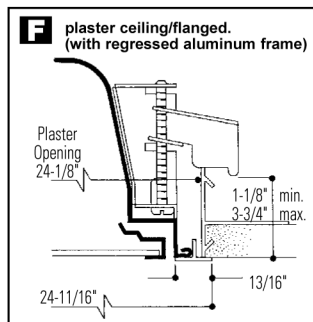
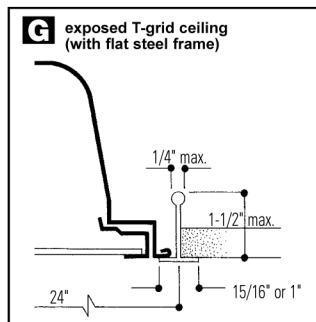

Dimensions

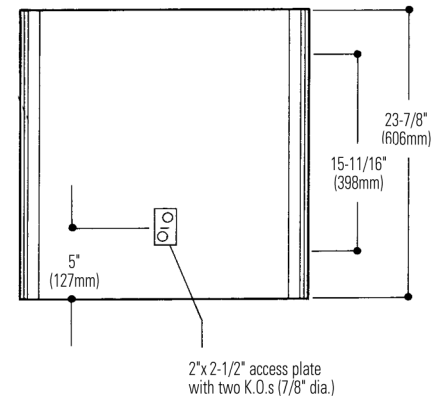
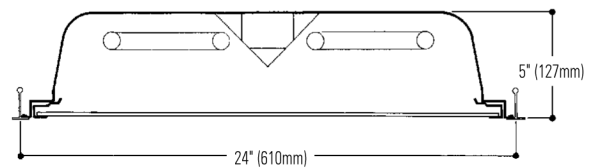

FIXTURE TYPE	VOLTS
JOB INFORMATION: _____	



FLUORESCENT